



monitor & identify the main
caries causing bacteria with
SALIVA-CHECK MUTANS
in 15 minutes!



Cavities and pre-cavitation white spot lesions indicate an active disease caused by cariogenic bacteria such as streptococcus mutans.

Enhance preventive measures and motivate your patients with SALIVA-CHECK MUTANS, a simple and accurate chairside test which detects the patients level of streptococcus in only 15 minutes.



Motivate & Educate

Why test your patients' Streptococcus mutans level?

The Streptococcus mutans bacterial species plays a leading role in the initiation of dental caries. When used with other clinical information, salivary levels of this bacterium is useful for caries risk assessment in patients.

Accurate results in just 15 minutes

Using a very specific immunochromatography process, SALIVA-CHECK MUTANS is not reliant on bacteria growth, this means **incubators** or other devices are not needed. Therefore, the traditional culture test is no longer necessary and **accurate results are available in just 15 minutes**. Accuracy is possible as the test strip contains 2 monoclonal antibodies that **selectively detect** only the S. mutans species, meaning no other bacteria contaminates the results.

In cases of positive results, a red line is shown on the test (T) line - meaning the patient has a level of S. mutans equal to or above 500 000 colony forming units per ml (cfu/ml) saliva.

Who to test

- New patients – particularly children and the elderly
- Patients with lower natural oral protection because of low salivary flow
- Patients with an acidic diet, low oral pH or high frequency of fermentable carbohydrates
- Patients undergoing periodontal treatment due to higher risk of root surface caries
- Patients before extensive restorative treatment to avoid recurrence of cavitations
- Expecting parents or guardians, to prevent transmission

Patients identified with high levels of Streptococcus mutans may benefit from a treatment program that includes using MI Paste™ or MI Paste Plus™

900210 SALIVA-CHECK MUTANS
Contains 10 Test Kits, per Kit:
Mutans Test Device (1),
Paraffin Gum (1), Pipette (1),
Mixing Container (1),
1 Bottle of Reagent #1 (2 ml),
1 Bottle of Reagent #2 (4 ml)

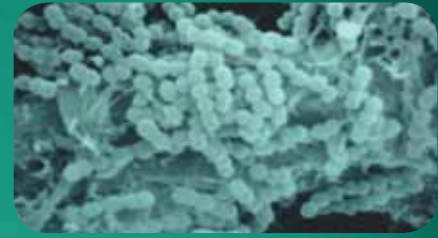

15 min



1. Chew the wax, collect the saliva

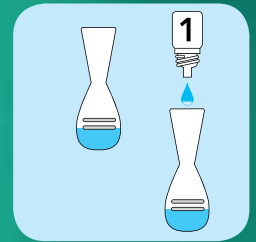

2. Add 1 drop of Reagent 1, tap the container 15 times

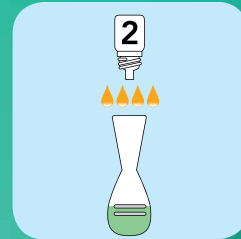

3. Add 4 drops of Reagent 2, shake until saliva sample becomes green

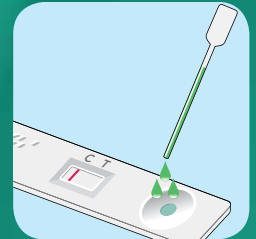

4. Dispense 3 scales of saliva in the sample window of the test device and wait 15 minutes

5. After 15 minutes, observe the Control line C and result in Test window T



a. Positive result - Either a faint or clear red line appearing means there are over 500 000 cfu/ml of S. mutans



b. Negative result - No red line appearing means there are less than 500 000 cfu/ml of S. mutans

