

## BONDING PROCEDURE

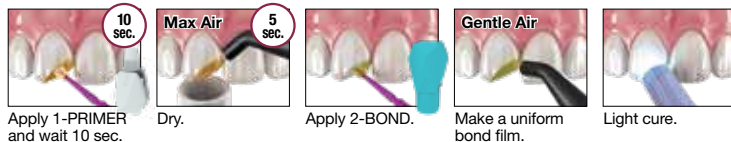

### ETCHING MODE SELECTION

Self etch

Selective etch 10-15 sec.

Total etch 10-15 sec.

Etch for 10-15 sec., rinse for 5 sec. and dry.

## INTRAORAL REPAIR

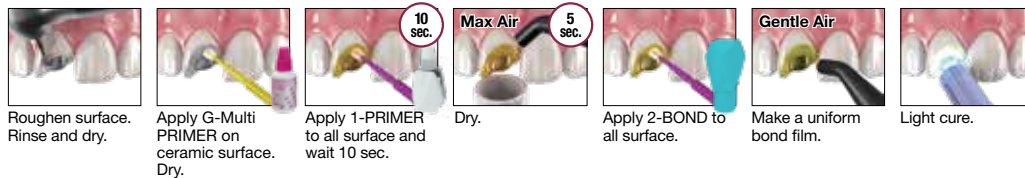

## SEALING OF TOOTH PREPARATION

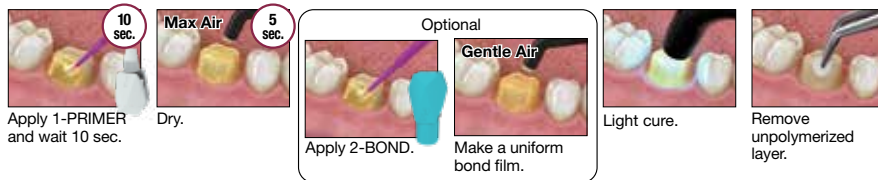

## LIGHT CURING TIME

Light curing unit	Distance from light guide tip	
	<10mm	>10mm
Halogen/LED (700-1200 mW/cm <sup>2</sup> )	10 sec.	20 sec.
High power LED (more than 1200 mW/cm <sup>2</sup> )	5 sec.	10 sec.

## FOR EASIER USE



Shake the bottle and dispense 1-PRIMER into "1" in disposable dispensing dish.



Dispense 2-BOND into "2" in disposable dispensing dish.

Push the top of the bottle cover (where the number is engraved) to make dispensing easier.

Do you keep your 2-BOND refrigerated?

Cold liquid is viscous and will be difficult to dispense, so please **allow** the 2-BOND bottle **reach room temperature** before dispensing.

Are you almost running out of the 2-BOND?

The bottle is designed to stand upside down. Liquid will be dispensed easier if you rest the bottle upside down, especially when the bottle is getting empty.

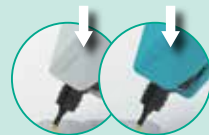

## Make the most of the bottle covers!

G2-BOND Universal has a unique packaging based on **ergonomic** principles. The bottle covers, 1 and 2 respectively correspond to product bottle caps and labels. So they must be placed correctly prior to dispensing.

### Why should you use the bottle covers:

- They **protect from excess heat** and limit evaporation.
- They **give greater control** to dispensing precise drops and minimize waste.
- Their design optimizes the **exact pressure** needed to extrude the drops for each bottle, depending on the viscosity.
- They are **reusable**, so they offer a more eco-friendly solution.
- They can be **easily cleaned** with water or with alcohol.
- An autoclave and other chemical solution should not be used.



Consult  
Instructions  
for Use